

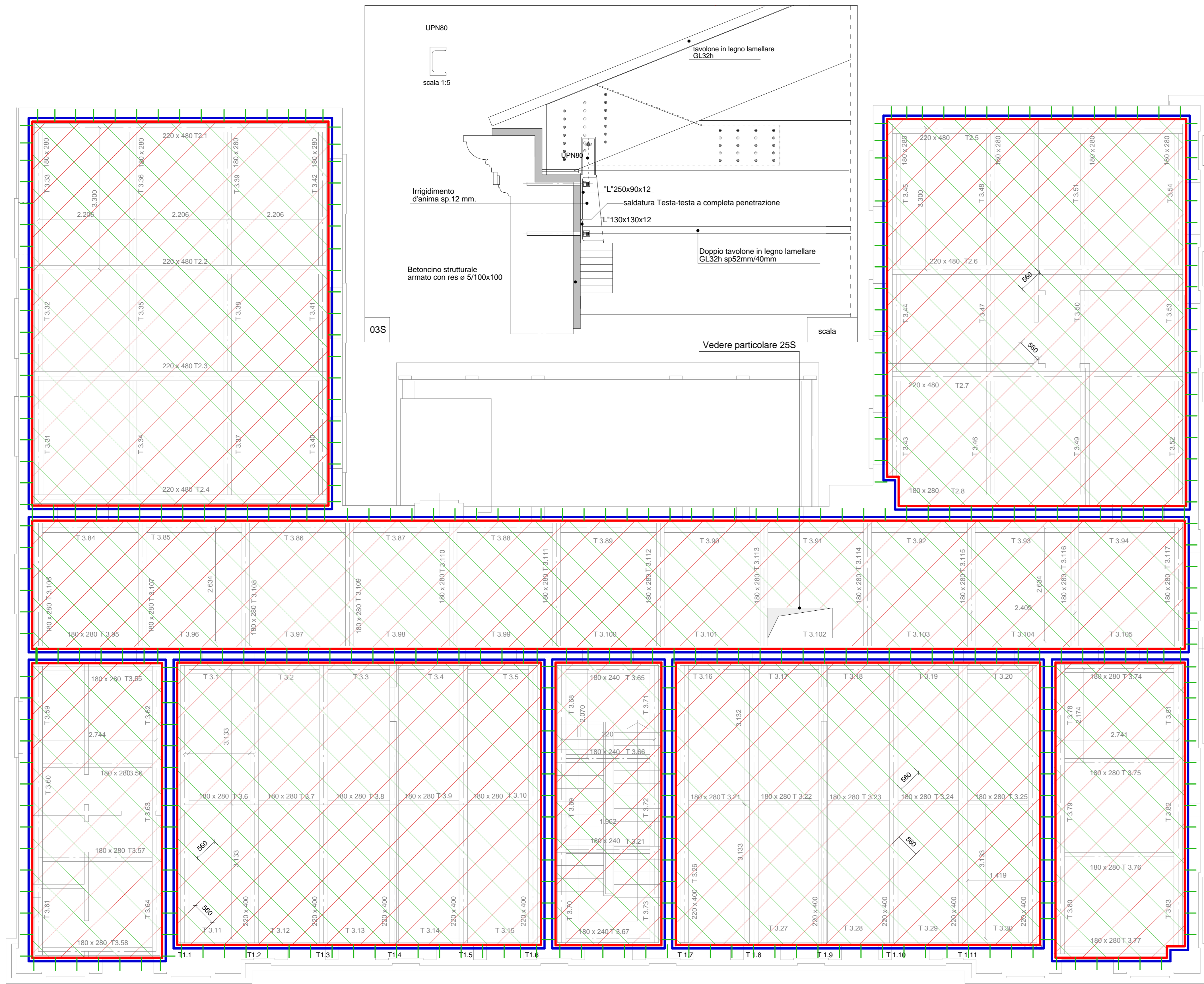

SOLAIO SOTTOTETTO

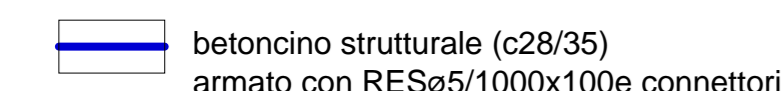
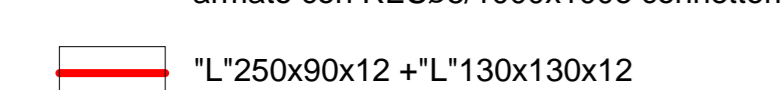
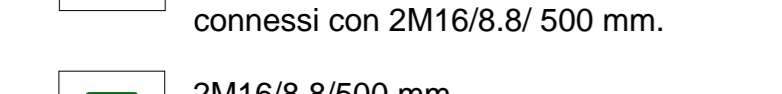
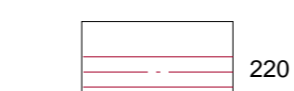
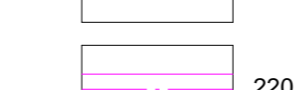
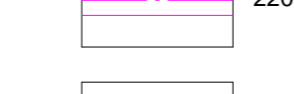

-  betoncino strutturale (c28/35) armato con RESø5/1000x100e connettori
-  L*250x90x12 + L*130x130x12 connessi con 2M16/8.8/ 500 mm.
-  2M16/8.8/500 mm.
-  1°tavolato
-  2°tavolato

-  220 x 480
-  220 x 400
-  180 x 280